

PRORIL

60Hz

GOMAX Series, these non-clog pumps employ a single-channel enclosed impeller to efficiently and reliably transfer 76mm diameter solids without clogging. GOMAX series pumps are suitable for commercial and industrial wastewater applications.

Sewage Pump

GOMAX 337/437

Single Channel Pump



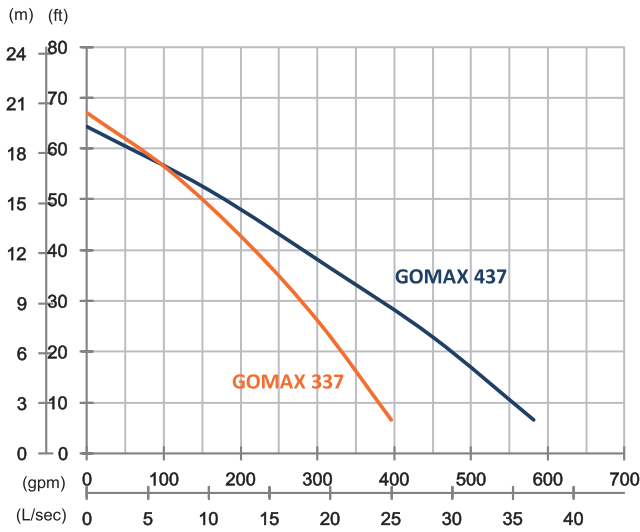

	GOMAX 337	GOMAX 437
OUTPUT	5 HP (3.7 kW)	5 HP (3.7 kW)
OUTLET	3" (80 mm)	4" (100 mm)
SOLID PASSAGE	3" (76 mm)	3" (76 mm)
Weight	207 lbs/94 kg	214 lbs/97 kg
HEAD	Rated: 41 ft, 12.5 m Max: 67 ft, 20.4 m	Rated: 36 ft, 11.1 m Max: 64 ft, 19.6 m
FLOW	Rated: 211 gpm, 13.3 L/s Max: 396 gpm, 25 L/s	Rated: 317 gpm, 20 L/s Max: 581 gpm, 36.6 L/s

Pump Type	Electric Submersible Pumps	
Motor	Phase	3-Phase
	Type	Induction Motor
	Poles	4 Pole (1750 rpm)
	Insulation	Class F
	Protector	Circle Thermal Protector
	Starter	D.O.L.
Lubricant	Food Grade (ISO VG32)	
Specs.	Impeller Type	Single Channel
	Shaft Seal	Double Mechanical Seal
		Silicon Carbide VS Ceramic/Carbon
	Bearings	C3 Shielded ball bearings
Cable	CSA-Certified PVC Jacketed Cables	
	33 ft (10 m) or longer upon request	
Materials	Pump Casing	Gray Iron
	Impeller	Gray Iron
	Motor Frame	Gray Iron
	Motor Shaft	Stainless Steel
	Mouth Ring	Copper Alloy
Max. Liquid Temperature	40°C (104°F)	
Max. Submersion Depth	20 m (66 ft)	
pH Range	pH 5 - pH 8	
Guide Rail	GRN-03	

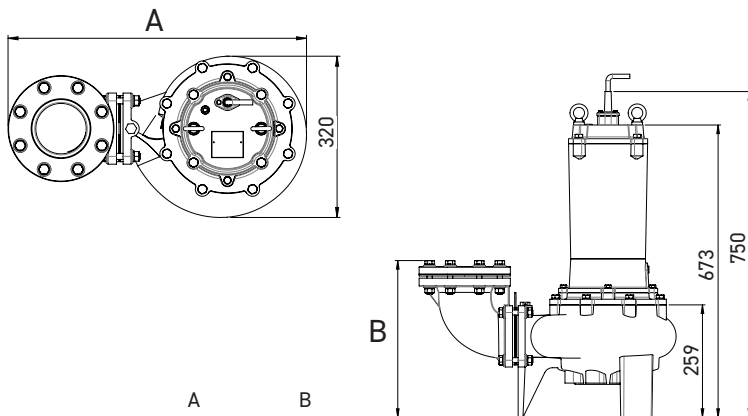

	A	B
GOMAX 337	580	342
GOMAX 437	589	349

unit : mm
C.W.L : Continuous running water level
L.W.L : Lowest running water level